

## **SUB-CRITERION: 7.1.4**

**7.1.4 Link for relevant document**

## Water Conservation Measures

Control objective	Control(s)	Audit Observation
<p>Minimize consumption of water.</p>	<p>Repair sources of water leakage, such as dripping taps and showers as quickly as possible.</p> <p>Install appliances which reduce water consumption</p> <p>Encourage a decrease in water usage among staff, students and conference guests</p> <p>Purchase the most efficient washing machines and dishwashers available which have an economy setting as default</p> <p>Use an efficient and hygienic water storage mechanism is to minimize the loss of water during storage</p> <p>Minimize wastage of water and use of electricity during</p>	<p>Regular checking and maintenance of pipelines are done to control water wastage. Practiced as much as possible.</p> <p>Yes, the institute encourages a decrease in water usage among staff, students and conference guests to curb water consumption.</p> <p>No, institute has not purchase the most efficient washing machines and dishwashers available which have an economy setting as default. This equipment is not required.</p> <p>No, the institute does not use an efficient and hygienic water storage mechanism to minimize the loss of water during storage as stored water is provided by the local municipality.</p> <p>All the departments have Water</p>
	<p>water filtration process, if used, such as RO filtration process and ensure that the equipment's used for such usage, are regularly serviced, and the wastage of water is not below the industry average for such equipment's used in similar capacity</p> <p>Install Water recycling mechanism, such as rain water harvesting system</p>	<p>filter with RO (Aqua guard) and large water filter with cooler at the strategic locations in the institute for the students.</p> <p>Classrooms have labels on the switchboards to remind students and faculties to save electricity.</p> <p>The Institute has Rain Water Harvesting system on all the buildings.</p>

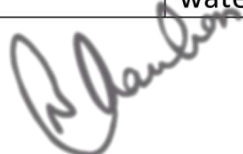

# Water Supply System

PRODUCED BY AN AUTODESK EDUCATIONAL PRODUCT

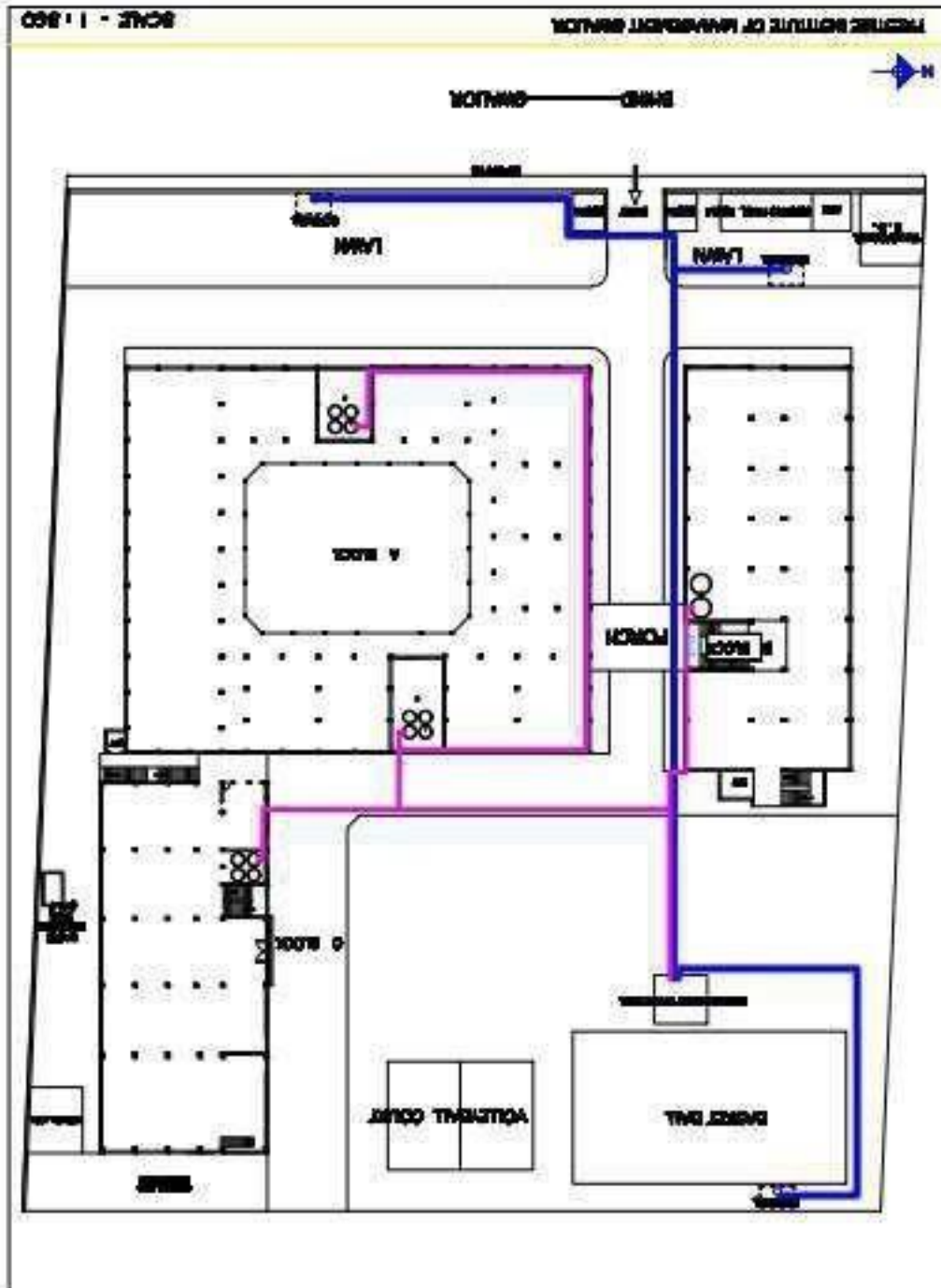

PRODUCED BY AN AUTODESK EDUCATIONAL PRODUCT